

Counting squares 2

1 Here is a plan of a child's bedroom.

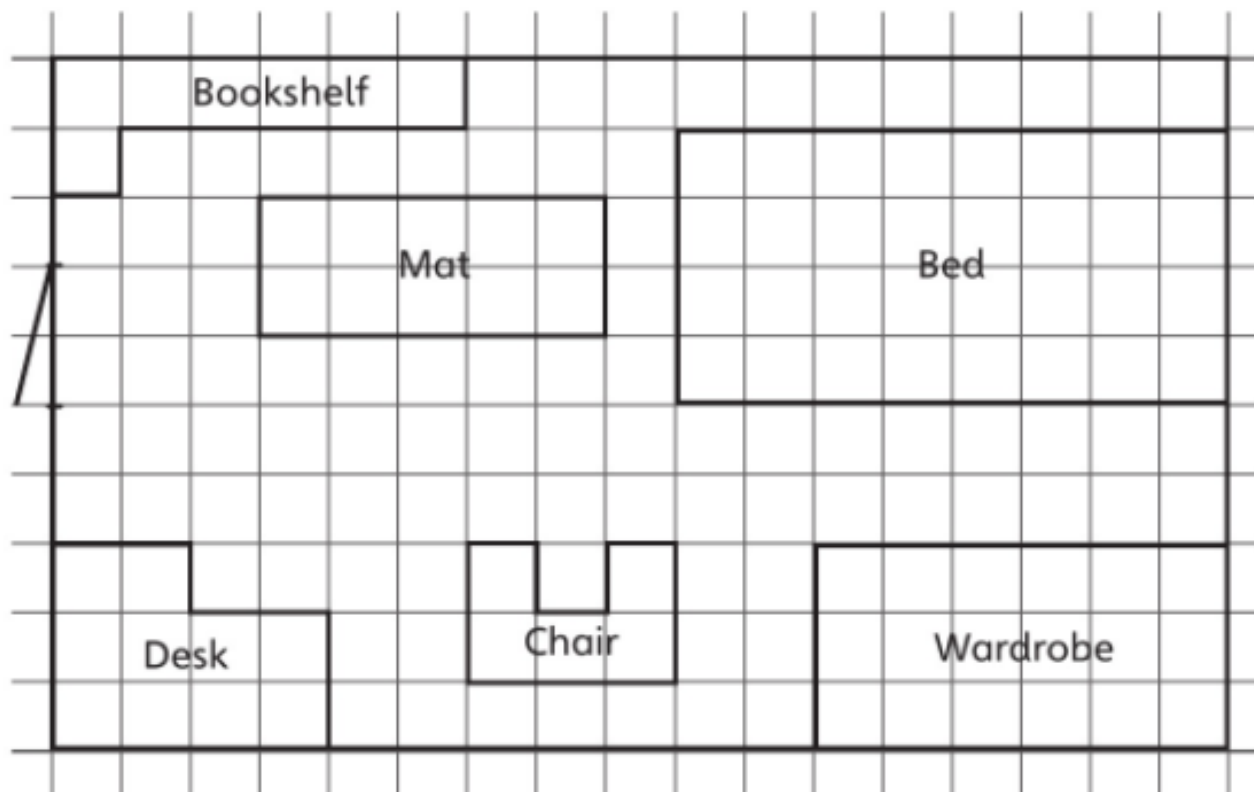

- a) Complete the table to show the area of each object on the plan.
- b) Draw your own object on the plan and in the last line of the table write down its area.

| Object | Area (squares) |
|-----------|----------------|
| Desk | |
| Chair | |
| Wardrobe | |
| Mat | |
| Bookshelf | |
| Bed | |
| _____ | |

- 2 Look at the shapes and complete the statements.

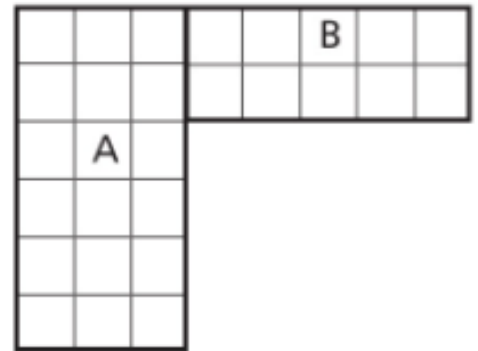

Rectangle A has an area of squares.

Rectangle B has an area of squares.

Area of A + B = squares + squares = squares

The whole shape has an area of squares.

- 3 A shape is made up of two rectangles joined together.

The first rectangle has twice the area of the second.

What could the total area be?

Draw your shape then work out its area.

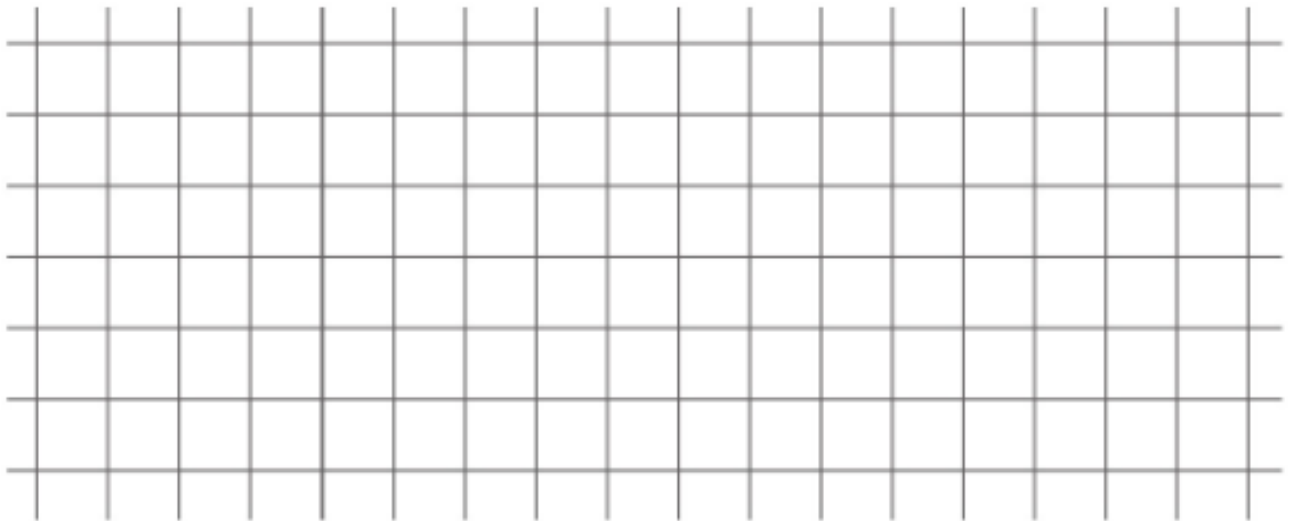

Total area = squares + squares = squares

- 4 What is the area of the shaded shape?

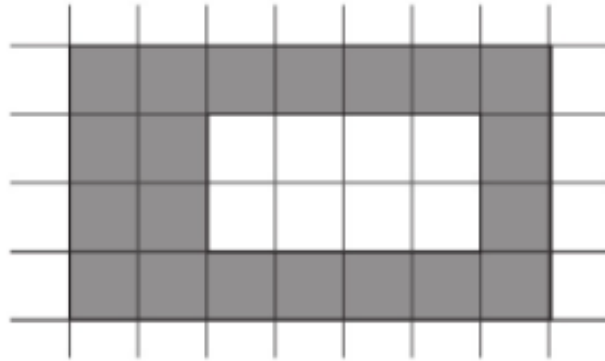

- 5 A farmer wants to split his land into 5 fields, all the same area.

On the map, the grey square shows the farmhouse and the rest of the squares show the area of the land around it.

Draw lines on the map to show how he can split up his land.

MAP OF OAK FARM

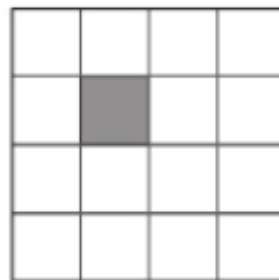

CHALLENGE



I have found a way to do this where the fields are all the same shape, too!

Reflect

Abdul puts a cardboard shape on top of some squared paper. How would you help him to find the area of the shape?

- _____
- _____
- _____
- _____